

Belvac Production Machinery Technical Bulletin

Information for Customers Operating and Maintaining Belvac Machines

ISSUE 12, VOLUME 11, SEPTEMBER 2008

Light Tester and Vision System Resolver/Encoder Coupling Alignment Tool

This Technical Bulletin details the proper way to align the coupling that drives the resolver or encoder used on the Light Tester or Vision system in a Belvac necker. The bracket must be installed using the tool described below to avoid misalignment between the resolver and/or encoder shaft and the driveshaft. Misalignment of these parts causes premature wear of the drive shaft coupling.

The coupling is designed to run with a parallel shaft misalignment of no more than 0.015 inches [0.381 mm] and an angular shaft misalignment of no more than 7.00 degrees. These parameters are tedious to obtain during assembly. An alignment tool (part number 3710621) was developed to align the couplings' mating parts and ensure an alignment that is better than the manufacturer's specifications detailed above.

The following procedure will eliminate excessive misalignment of the coupling during assembly. The item numbers and parts usage described can be found on assembly drawings 3710603 and 3720209.

Install the mounting bracket, part number 3710338 item 5337, and the drive shaft, part number 3710337 item 5334, with alignment tool, part number 3710621 item 1383 as shown in the sketch below. Ensure the alignment tool is pushed all the way onto the non-threaded end of its mating drive shaft. Tighten the mounting bolts that secure the bracket. Ensure the alignment tool will slide back and forth easily with mounting bracket and drive shaft in the assembled state. If not, loosen the bracket mounting bolts and realign using the tool. When the sliding fit of the tool is established with the parts in the installed position, install the coupling, part number C31336 item 5338, and the mating resolver or encoder (not shown).

*Contact Belvac Sales or Service
Representatives for additional information.
All Belvac Technical Bulletins may be viewed on
Belvac's web site, www.belvac.com.*

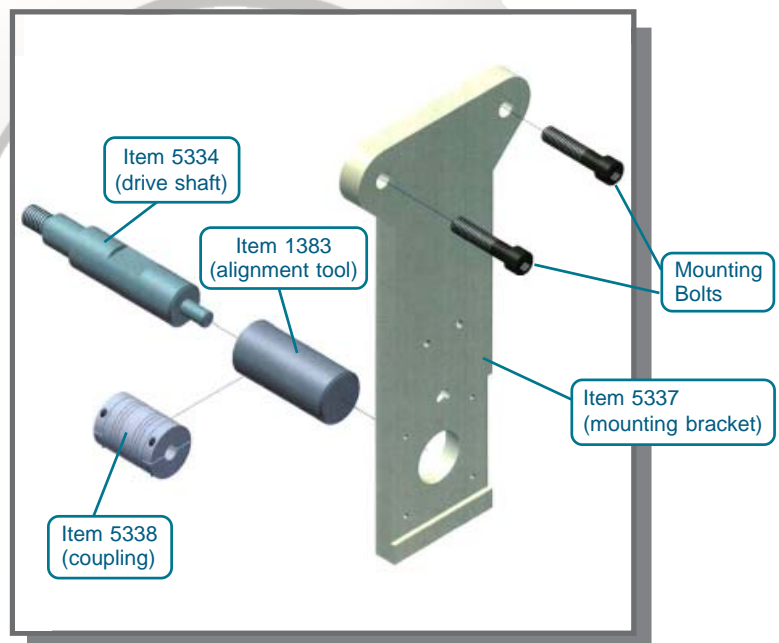

Belvac Production Machinery, Inc.

237 Graves Mill Road, Lynchburg, Va. 24502 USA Tel. (434) 239-0358 Fax (434) 239-1964
info@belvac.com <http://www.belvac.com>